



Oreocetes nana Nutt., a Wyoming endemic collected by Thomas Nuttall
on his journey across Wyoming in 1814

WYOMING NATIVE PLANT SOCIETY

May 1983

WYOMING NATIVE PLANT SOCIETY NEWS LETTER, Vol. 2 #4

New Members and Old: Since the last newsletter Vol. 2 #3 we have gained three new members. They are: David Bendix (Sheridan), Leta Schupack (Laramie), and Hollis Marriot (Laramie-Hulett). This brings our current membership to 51 active members. Several old members renewed their subscription this period. The cost of WNPS is \$7.00 for the first year and \$3.00 annually thereafter. RWL

Treasurer's Report: The last balance was \$262.20. Deposits = \$33.00; Returned debit from bank = \$3.00; Cost of newsletter 2(3) = \$21.60; Stamps = \$20.00; Corporation tax to Secretary of State = \$3.00. New balance = \$253.60. RWL

Other Names on our Mailing List: We continue to send and receive newsletters from the following plant societies: Colorado, Northern Nevada, Idaho, New Mexico, and West Virginia. RWL

North Fork Clover Patches:

Grassy openings interspersed with groves of Pinus albicaulis, Picea engelmannii, and Abies lasiocarpa are not unusual in the subalpine zone of Wyoming. However, on the botanically seldom trod eastern reaches of the Absarokas in the N. Fk. Shoshone River area, there is to be found, at high elevation usually on north facing slopes, an unusual and striking community that might be termed the Trifolium opening or park. Here two species, Trifolium haydenii and T. parryii, frequently form the dominant vegetation in the openings among the groves of conifers. These openings may be only a few square yards or up to an acre in extent. These parks contain exceptionally large sods of these two clovers to the virtual exclusion, in many instances, of all other species. Solid patches of T. haydenii 30 x 30 ft. are not uncommon and occasionally T. parryii is as extensive. So striking and impressive are these clover patches that an acquaintance (who twenty-five years ago manned a now abandoned fire lookout tower atop Clayton Mtn. in N. Fk. country) upon learning of my botanical investigations in the area asked immediately, "What's that clover growing all over Clayton?" The answer of course was T. haydenii, for surely this clover is preeminently abundant up there.

Other species commonly found in the openings are Castilleja rhexifolia, C. crista-galli, Haplopappus lyallii, Arnica cordifolia, Vaccinium scoparium, Achillea millefolium, Senecio crassulus, Carex albonigra, C. atrata, C. spectabilis, Poa epilis, P. incurva, Trisetum spicatum, Myosotis alpestris, Lupinus argenteus, Lupinus argenteus, and Astragalus miser.

These N. Fk. Trifolium openings are best developed at elevations of 9,700-9,800 ft. near the upper limits of the spruce-fir or subalpine zone on moderately deep well-drained soils. Thus far they have only been found in a relatively small area about twenty miles long on north facing slopes on the north ends of Wapiti Ridge and Sheep Mesa on the south side of the valley of the N. Fk. Shoshone River. Interestingly, T. haydenii and T. parryii are present at comparable elevations on the north side of the valley but are not dominant components of the vegetation here. Perhaps this is due to the fact that most of the topography here faces south rather than north. Another interesting feature concerning distribution and abundance of these clovers is that west of the Sheep Mesa, Trifolium openings and all species of high altitude clovers (including also T. nanum and T. dasyphyllum) are absent entirely despite miles and miles of suitable habitat. In ten years of collecting the area, I have not encountered any of these clovers on any of the high Yellowstone Park boundary peaks and ridges that form the western rim of the N. Fk. drainage system. Perhaps this anomaly of distribution has something to do with the glacial history of the area. EFE

1982 Field Work: The following novelties are result of my 1982 field season.
TWL

State Records

- Aira caryophyllea - with Jennifer Whipple & Don Despain
- Veronica arvensis - with Evert & Dorn
- Polygonum scandens - with Dorn

Unusual finds

- Shoshonea pulvinata - Owl Creeks
- Physaria condensata - common in Lincoln County
- Stanleya pinnata var. gibberosa ? - Owl Creeks, showed same variation as type locality for this variety at Ft. Bridger; used for contrast to lump this variety.
- Townsendia - no pappus or ligulate flowers, will search for more this season.
- Juglans nigra - mouth of Trapper Canyon; several feet in diameter
- Gratiola neglecta - new to me.

Quotes Worth Requoting: I was not on vacation and was collecting in the Ferris Mountains in 1981 with R. Dorn, who was on vacation. The temperature was about 90° and the following happened: After several hours of hiking ridge after ridge, we stopped to look at the next upcoming ridge when Dorn said, "We can take our time now, no need killing ourselves." I replied, "That's right, you're on vacation." He responded, "You're not!" RWL

Dugout Gulch: The following letter was received on 23 April '83.

I recently received a copy of the Wyoming Native Plant Society News Letter (Vol. 2, #3) and noticed the report on Dugout Gulch. Several months have passed since Barry Johnston's report and I need to bring you up to date on the status of the proposed road in Dugout Gulch.

To date no decision has been made on the road. Within the next two months an addendum and Decision Notice will be prepared to address the concerns of both the Wyoming Native Plant Society and some other individuals. Several other proposed roads in Dugout Gulch and Hospital Gulch will be discussed. I will send you copies of the addendum and Decision Notice.

Peter L. Johnston
District Ranger

Annual Meeting:

As proposed in our last newsletter we will be having our annual meeting at South Pass. The time and place are as follows: the meeting place will be on the NE rim of Oregon Butte that is bisected by the large oil field road, at 3:00 PM the 2nd of July. If it's windy (and it no doubt will be), then continue eastward on the road to the bottom (see map). RWL

Agenda

Saturday 2 July

- 3:00 - 4:00 minutes, treasurer's report, etc.
- 4:00 - 6:00 short field trip; Lesquerella macrocarpa, Phacelia demissa, Cryptantha scoparia, etc.
- 6:00 - -- supper, cash bar

Sunday 3 July

- 8:00 - 12:00 field trip; Lesquerella fremontii, Townsendia nuttallia, Antennaria arcuata; Trifolium barnabyi, etc.

Camping: Due to this year's location and time, we anticipate most local campgrounds to be full. So, bring your own water and supplies in preparation for rustic camping.

Books: Written by Robert Mohlenbrock, winner of a 1979 Audubon Society Conservationist Award, WHERE HAVE ALL THE WILDFLOWERS GONE? A Region-by-Region Guide to Threatened or Endangered U.S. Wildflowers is the first and only wildflower guide of its kind available. "In captivating anecdotes and thorough research, Robert Mohlenbrock not only writes an excellent field and reference guide on our vanishing wildflowers, but he also pinpoints the undeniable need to preserve one of our country's most beautiful and neglected resources. WHERE HAVE ALL THE WILDFLOWERS GONE? should be appreciated by anyone interested in America's natural heritage." --Senator Charles H. Percy of Illinois.

WHERE HAVE ALL THE WILDFLOWERS GONE?: A Region-by-Region Guide to Threatened or Endangered U.S. Wildflowers

By Robert H. Mohlenbrock

Illustrated by Mark W. Mohlenbrock

Publication Date: May 4, 1983

Price: \$15.95, cloth

Pages: 256

ISBN: 0-02-585450-X

40 color photographs; 80 line drawings

For more information contact: Becky Goodwin (212)935-6760.

Volume 6 of the Intermountain Flora by Arthur Cronquist, Arthur Holmgren, Noel Holmgren, James Reveal and Patricia Holmgren is being offered for sale for \$30. This volume is the second to be issued in this series and treats the monocotyledons. This impressive 584 page work includes such important families as grasses, sedges, rushes, agaves, lilies, iris, orchids, etc. Many of these drawings were done by Jeanne R. Janish, Rupert C. Barneby, and Kaye H. Thorne. Informative footnotes describe habitat, geographical range, economic, medicinal, and other uses. To order Volume 6, send a check for \$30 and request #636, Science, from

Columbia University Press, 136 S. Broadway, Irvington-on-Hudson, NY 10533.

Election Time: It was decided last year at the annual meeting that each candidate should be contacted prior to election. So each of the following candidates has been notified prior to this election and has been originally nominated by R. Hartman and R. Lichvar. As soon as possible please send your ballots, plus your \$3 for renewal dues. If you don't pay your \$3 by 2 July then your membership has expired. You can use this ballot when returning your vote. RWL

President

Dave Martin --
E.F. Evert --

Secretary/Treasurer

Virginia Wheeler --
Lisa Engretson --

Vice-President

Hollis Marriot --
Mark Stromberg --

Board Member

Andy Warren --
Ann Aldrich --

\$50 donation for west slope of Colorado flora

yes _____
no _____

Botanical Novelties: Next time.

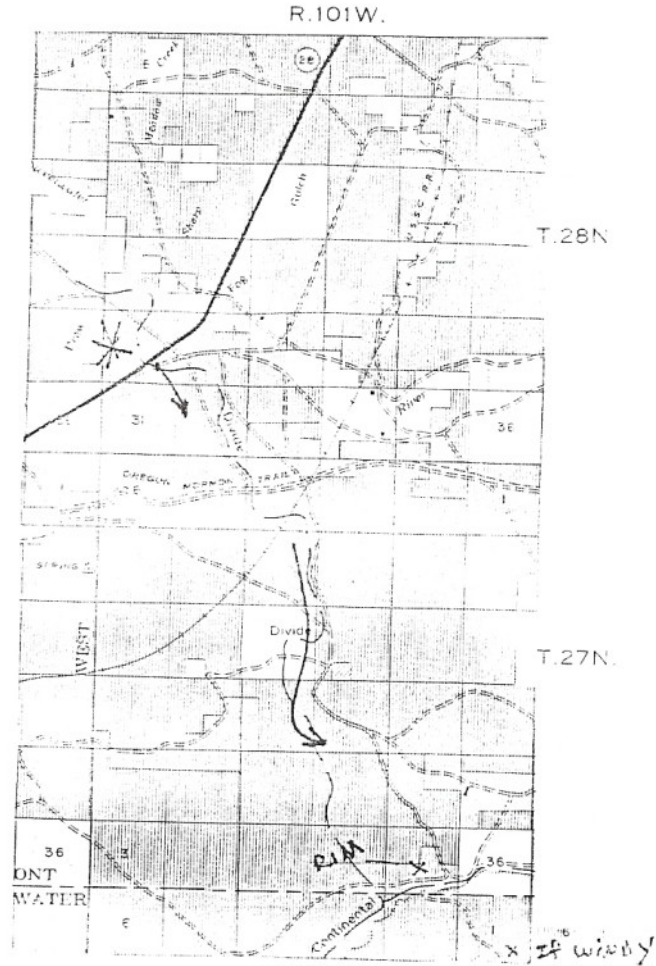

T28N R101W S30, if windy go to T27N R101W S35.

Wyoming Native Plant Society
1603 Capitol Ave. Rm. 325
Cheyenne, WY 82001